



Technical data

	Designation		PMK 0,15	PMK 0,3	PMK 0,4	PMK 0,5	PMK 0,6
1	Starting current*	Nm	0.15	0.3	0.4	0.5	0.6
2	Max. permissible speed**	rpm	760	380	280	230	190
3	Max. permissible slip power***	W	12	12	12	12	12
4	Max. permissible operating temperature	°C	60	60	60	60	60
5	Rotor moment of inertia	kgm ² x 10 ⁻³	0.0197	0.0220	0.0235	0.0251	0.0279
6	Weight	kg	0.34	0.35	0.35	0.36	0.36
7	Degree of protection	-	IP40	IP40	IP40	IP40	IP40
8	Product code	-	020a-116	020a-085	020a-132	020a-086	020a-133

* Rated torque set to +/- 10%. Different torque values can be applied on request.

** This is limited by the residual torque and the maximum permissible slip power.

*** Value determined at room temperature (22°C). Taking into account the maximum permissible operating temperature, the brakes may also be overloaded momentarily.

Dimensions

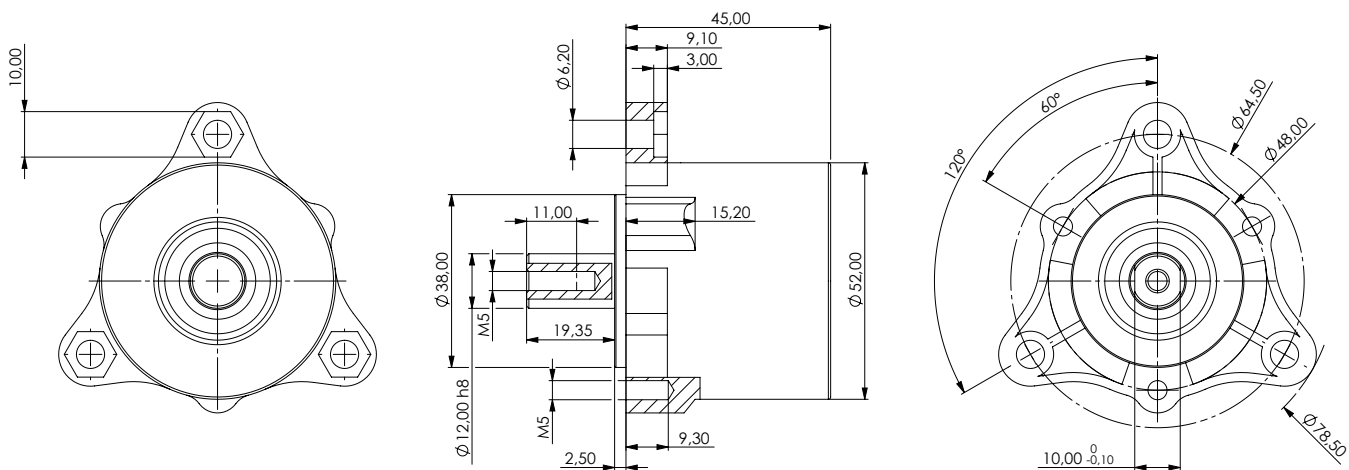

The drawings and data in this document are provided as general information for our customers. For specific use cases, a separate quotation must be requested. Kern Antriebstechnik GmbH accepts no responsibility for any errors found in the respective datasheets. Kern Antriebstechnik GmbH reserves the right to make changes to its products without prior notice. This also applies to products currently available on the market, provided that – unless otherwise specified – the modification in question does not restrict the product's usability. All goods and trademarks mentioned in this datasheet are the property of Kern Antriebstechnik GmbH.